



SavAwn Awnings: *You've made a great decision!*

Congratulations on your purchase of SavAwn Awnings—the awnings that save you money! SavAwn Awnings are high quality window coverings designed to be both pretty and practical. Not only do they add style and appeal to your home...they enable you to save significant money on utility bills...month after month!

Your purchase is appreciated! And, because we want your awnings to look great for years to come, please follow fabric care guidelines below:

- **To remove wrinkles after installation, spray the awning with water and allow it to dry in direct sunlight.**
- **If desired, a mild soap solution can be used to clean awning fabric. Avoid washing with bleach or harsh chemicals.**
- **Use an ordinary household broom to keep the underside of awnings clean.**
- **If awnings are stored, keep them in a dry area where they can breath (do not place them in a non-breathable plastic bag).**
- **Some insect repellents may cause fabric staining.**
- **Do not allow debris such as twigs and leaves to accumulate and remain on awnings.**

SavAwn Awnings come with a complete 3-year quality warranty. This warranty covers both the fabric and the hardware for a three-year period of normal use. It includes the following:

- **Manufacturer's defects**
- **Hardware breakage**
- **Rusting of hardware**

Our company has a long tradition of success, brought about by a genuine concern for our customers. If you have a problem...let us help. www.SavAwn.com

ASSEMBLY INSTRUCTIONS

NOTE: This awning that you have purchased should exceed the width of the window. All awnings above a doorway need to have allowed clearance space for the door to open. For installation in concrete or brick walls # 10-12 plugs should be used. (Not included)

Step 1. Identify all parts from the part list and picture.

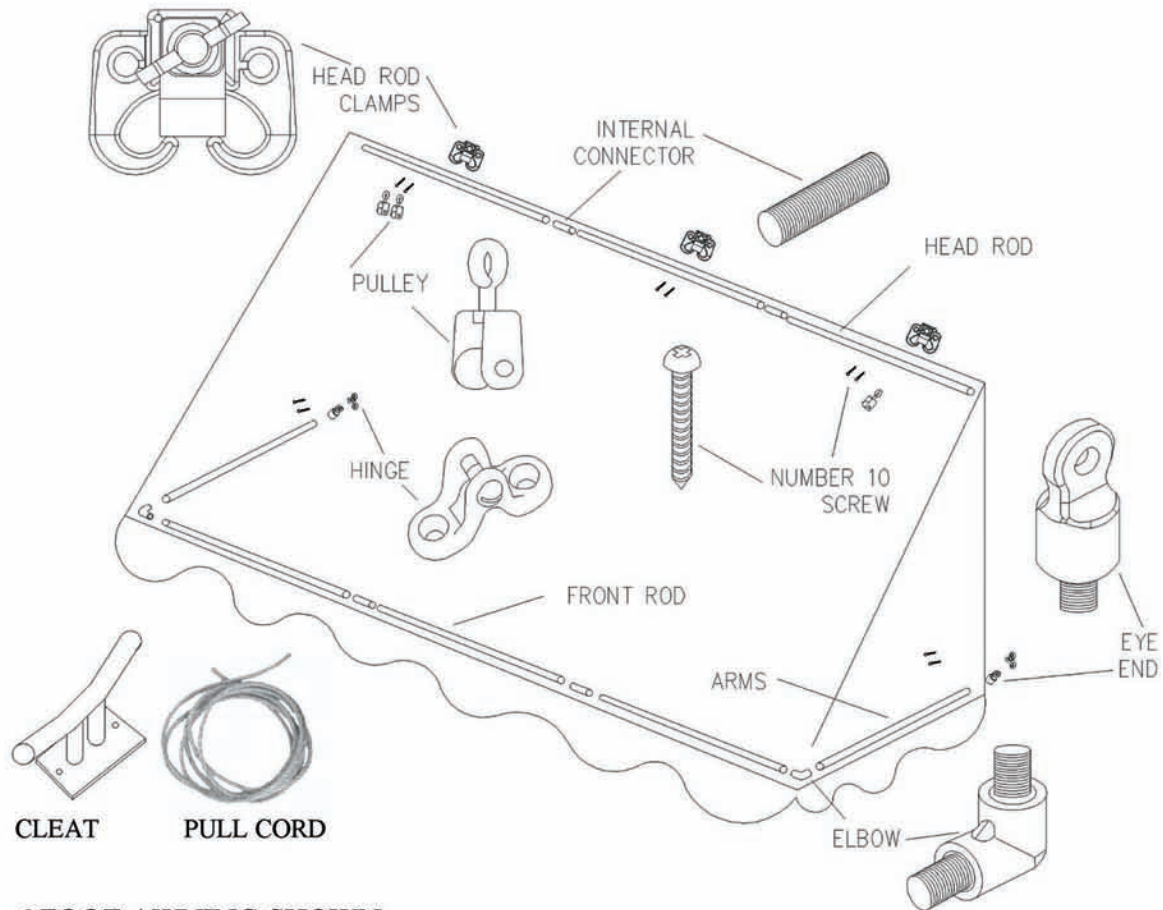

6 FOOT AWNING SHOWN

Awning	4'	6'	8'
Number 10 Screws	10	12	14
Pipe Sections	6	8	10
Internal Connectors	2	4	6
Pulleys	3	3	3
Head Rod Clamps	2	3	4
Elbows	2	2	2
Hinges	2	2	2
Eye Ends	2	2	2
Awning Fabric	1	1	1
Pull Cord	1	1	1
Tie Down Cleat	1	1	1

AWNING INSTRUCTIONS CONTINUED

Step 2.

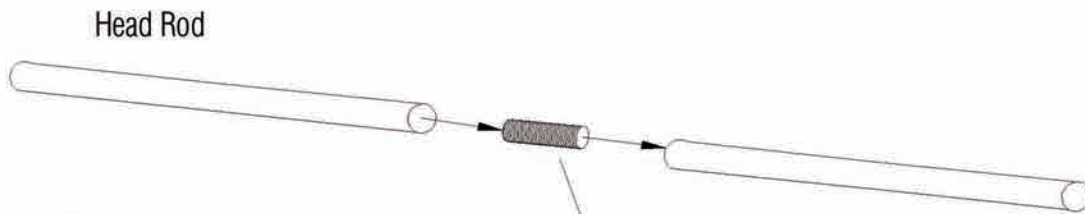

Step 3.

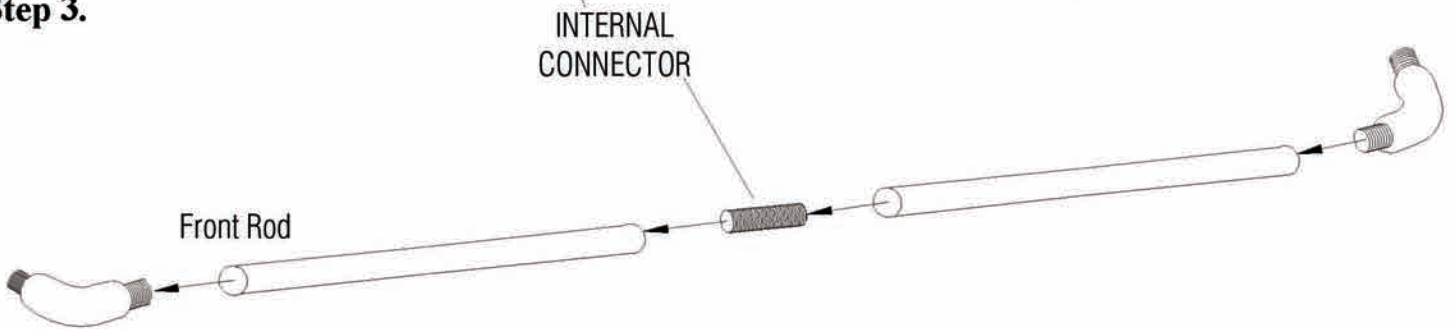

Step 4. After Head Rod (top) and Front Rod are tightened securely, Slide Head Rod (top) and Front Rod into awning sleeve.

Step 5. Install arms into awning sleeves then thread arms into elbows.

Step 6. Attach side arms to the elbows then attach Eye Ends to the side arms.

Step 7. Mount one Head Rod Clamp per Head Rod pipe used leaving 6" on both ends. Attach the pulleys to the Head Rod Clamps as shown.

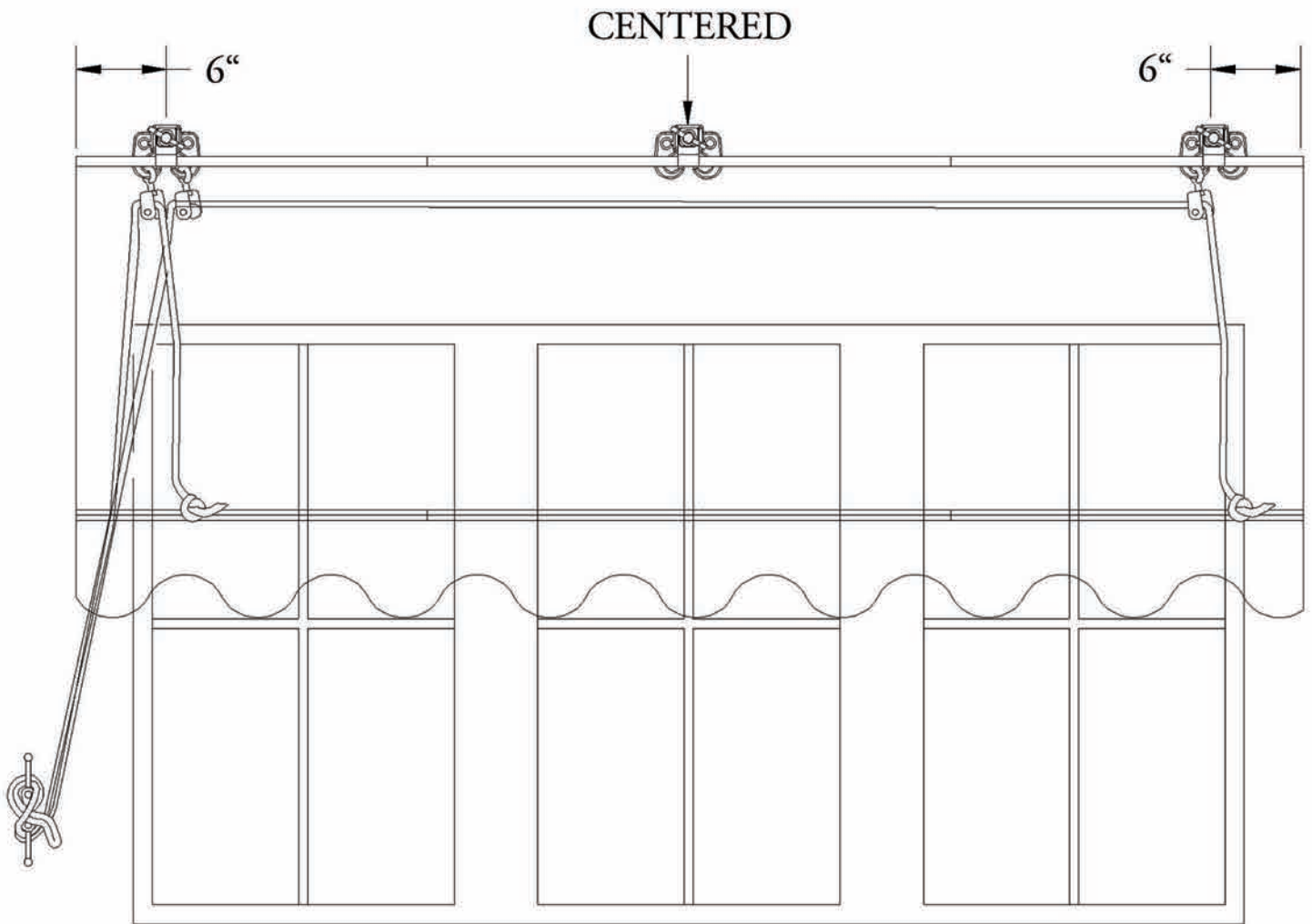

6 FOOT AWNING SHOWN

- Step 8.** Attach the Head Rods to the clamps then straighten the Front Rod. Make sure the awning side arms are level, then screw the hinges into the wall. Attach the Eye Ends to the hinges.
- Step 9.** Tie the pull cord to the Front Rod and thread the pull cord through the pulleys as shown. Wrap the pull cord around the Tie Down Cleat.
- Step 10.** Remove wrinkles after installation by spraying the awning with water and allowing it time to dry in direct sunlight.

Thank You for your purchase of SavAwn Window Awnings